

**HOLMAN**

# 7m Misting Kit with SwapLock™ Fittings



PRODUCT CODE  
**MK31007**

[www.holmanindustries.com.au](http://www.holmanindustries.com.au)

## User Guide

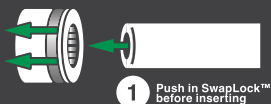

1 Push in SwapLock™ before inserting



2 SwapLock™ will click into place

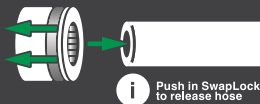

i Push in SwapLock™ to release hose

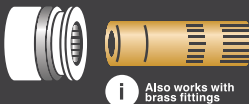

i Also works with brass fittings



 **SwapLock™**  
INTERCHANGEABLE FITTINGS

**SwapLock™ Misting Fittings** are the ultimate solution for a flexible misting system. Internal teeth ensure a **secure fit**, and the unique locking system allows the hose and fittings to be disconnected and reused in different configurations.

# Contents

Overview	4
Outdoor Cooling Misting System	4
The Way it Works	4
Benefits of a Misting Tap Timer	5
Components	6
Installation	7
Plan Your Misting Installation	7
Water Supply	8
Positioning Misting Jets	9
Installing the Fittings	10
Installing the Misting System	11
Flushing the System	13
Water Filter	13
Auto Drain Valve	14
Maintenance	15
Drain Water from your System	15
Clean Nozzles	15
Flush System	15
Clean Filter	15
Clean Nozzles	15

# Overview

## Outdoor Cooling Misting System

---

### **⚠ PLEASE READ INSTRUCTION MANUAL BEFORE USE**

- ✓ Your **7m Misting system** features 7mm diameter high **PRESSURE TUBING** with **PRESS-RELEASE FITTINGS** that are made to match this tubing
- ✓ These **FITTINGS** are designed to grip the **HOSE** and **NOZZLES** internally and release when the **FITTING END PIECE** is pressed, allowing systems to be adjusted and changed. No clamps are required
- ✓ Your **7m Misting system** can be expanded with more **Holman misting parts** by purchasing the **Holman Misting Expansion Kit**, available at your Holman stockist

## The Way it Works

---

- i** Your **misting system** cools air by evaporating fine water particles emitted by **MISTING NOZZLES**
- i** Misting nozzles emit small amounts of water. It also breaks the water into very small droplets or a mist
- i** In hot conditions, small water droplets evaporate almost instantaneously. In cooler or humid conditions the evaporation rate is slower
- ⚠ Do not run your misting system continuously. It dampens the surrounding area**
- i** Solve this issue by using a **Holman Misting Timer**

# Overview (continued)

## Benefits of a Misting Tap Timer

---

- ✓ To achieve the best misting results install a **MISTING TIMER**
- ✓ Regulate the amount of water entering a space by adjusting the **ON** times and **OFF** times of the timer
- ✓ **MISTING TIMERS** allow you to make these settings in seconds, where other timers may not have this feature
- ✓ We have several Tap Timers available with misting settings:

# BX1

Bluetooth Tap Timer



Our single outlet **BX1 Bluetooth® Tap Timer** includes a Misting Timer function and is the perfect companion to your **Charcoal Misting Kit**.



SCAN FOR MORE INFO

# WX1

Wi-Fi Tap Timer



Our **WX1 Wi-Fi Tap Timers** include a Misting Timer function and are the perfect companion to your **Charcoal Misting Kit**.



SCAN FOR MORE INFO

Also available:

# MISTING TAP TIMER

CO1609



Beat the heat and complete your outdoor misting setup! Perfect for the short-burst intervals needed to create a cool environment outdoors.



SCAN FOR MORE INFO

# Overview (continued)

## Components

---

1. 1× 7m Misting Hose
2. 5× SwapLock™ Tees
3. 2× SwapLock™ Elbows
4. 1× Universal Tap Adaptor
5. 5× SwapLock™ Brass Misting Nozzles
6. 1× Misting Filter
7. 1× SwapLock™ Hose Adaptor
8. 1× SwapLock™ Auto Drain Valve
9. 15× Hose Clamps



# Installation

## Plan Your Misting Installation

- i** Take 5 minutes to work out how you will run the misting **PIPEWORK**
- i** Consider where to position **MISTING JETS**, where your **WATER SOURCE** will come from and where the supply **PIPELINE** will run
- i** Position **MISTING JETS** to create a “mist curtain” surrounding your outdoor entertainment area
- i** Position **MISTING JETS** away from tables, chairs and sitting areas as **MISTING JETS** may drip water
- i** Work out what you can attach the **PIPEWORK** to and plan a route that makes attaching **PIPEWORK** easy

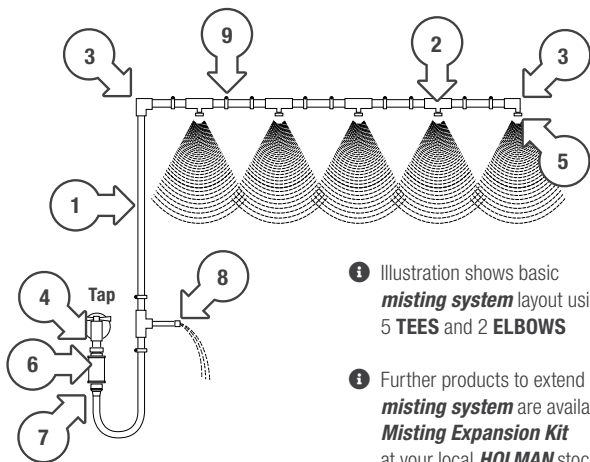

- i** Illustration shows basic **misting system** layout using 5 **TEES** and 2 **ELBOWS**
- i** Further products to extend your **misting system** are available in the **Misting Expansion Kit** at your local **HOLMAN** stockist

# Installation (continued)

## Water Supply

**!** Use only fresh tap water. Bore or dam water may contain sediment and block jets

**i** Your **7m Misting system** uses very little water volume. Each jet uses 2L/hr

**i** Your **7m Misting system** works best with a high pressure water supply

**i** The higher the pressure the more effective the droplet evaporates and cools an area

**i** Normal household water supply is usually at an adequate pressure

**i** Connect **MISTING TUBE** [1], **HOSE ADAPTOR** [7] and **FILTER** [6] directly to **GARDEN TAP**, or use a **GARDEN HOSE** to bring water from a tap in the area to the start of the misting **PIPEWORK**

**i** Use **UNIVERSAL TAP ADAPTOR** [4] if connecting to 25mm **GARDEN TAP**



**i** If **HOSE** is running in the sun, ensure it is a good quality **HOSE** to withstand the pressure when water and **HOSE** are heated—refer to page 11 for [Garden Hose connection](#)

**i** **HINT:** easily maintain the use of your garden tap for other uses, install a [Holman 2 way](#) or [4 way Tap outlet](#) and fit the misting system to one outlet



# Installation (continued)

## Positioning Misting Jets

---

**i** Factors to consider are:

- Spacing of **MISTING JETS**
- Location of **MISTING JETS** over tables or chairs
- How many **MISTING JETS** in a particular area

**i** There are no fixed rules to how you position the **MISTING JETS**

**i** More **MISTING JETS** means more water used and the cooler the space will become

**!** **Too much water can be a problem—the air can become saturated and wet people and objects in the space**

**i** We recommend the following:



✓ Space **MISTING JETS** [5] between 600mm and 1000mm of **TUBE** [1]

✓ Locate **MISTING JETS** away from tables and sitting areas

✓ Create a curtain of mist on at least two sides of the area being cooled

✓ Install a **Holman Misting Timer** to regulate the amount of water entering a space by adjusting the **ON** and **OFF** times. You would have more **ON** time on a hot dry day than a cool moist day

# Installation (continued)

## Installing the Fittings

- i** Your **7m MISTING SYSTEM** features **SwapLock™ FITTINGS** [2]. These **FITTINGS** feature an internal ring of metal “teeth” to grip **MISTING TUBE** and **NOZZLES** and prevent them coming loose or leaking water
  - i** The metal “teeth” release the **TUBE** [1] and **NOZZLES** [5] when the end of the **FITTING** is pressed, allowing modification of the system
  - i** Cut the **TUBE** “square” and “burr free” to ensure a good joint
1. To install a **SwapLock™ FITTING**, bring end of **TUBE** and **FITTING** together, level and straight, pressing the end of the **FITTING**
  2. Push **TUBE** in as far as it can go

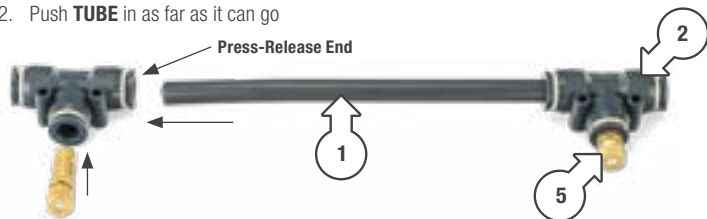

3. Do the same for the **NOZZLE**, ensuring the end of the **FITTING** is pressed

**⚠ Attempting to insert or remove the NOZZLE or TUBE without pressing the release-end of the FITTING can damage the internal metal teeth**

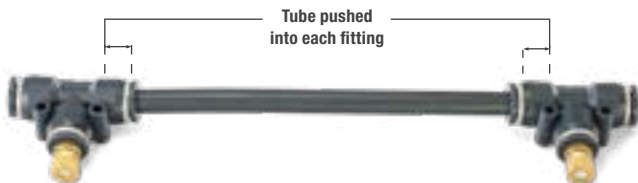

# Installation (continued)

## Installing the Misting System

**⚠** Each section of **TUBE** should be connected before attempting to pin your **7m MISTING SYSTEM** to walls or beams

1. Start at the garden tap or water source point

**i** If using a **GARDEN HOSE** [10], install a **12mm SPRINKLER ADAPTOR** [11] into the **MISTING FILTER** [6] as shown

**i** Run the **MISTING TUBE** [1] to the position you want your first **MISTING JET**. Use **SwapLock™ TEES** or **SwapLock™ ELBOWS** to go around corners or split the pipe runs

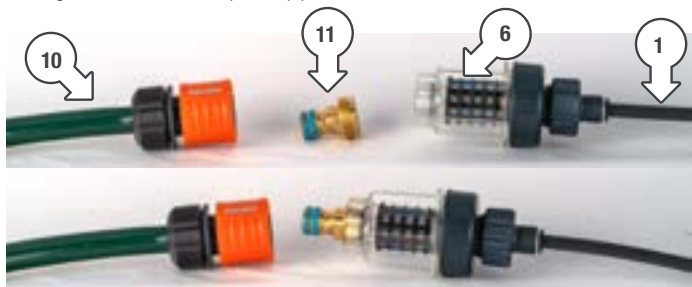

### 12mm Sprinkler Adaptor

8010HB

The Quick Release snap-on fitting makes installing and swapping between hose end products to your garden hose, quick & easy!



SCAN FOR MORE INFO



# Installation (continued)

## Installing the Misting System (continued)

---

2. Work out the spacing of the **MISTING JETS** [5] and cut the **MISTING TUBE** [1] to length and install the relevant **TEES** [2]
3. Finish each line with an **ELBOW** and **MISTING JET**
4. Use the **HOSE CLAMPS** [9] to attach the **MISTING TUBE** to the wall or beams
5. The **HOSE CLAMPS** use a very strong masonry nail that should not bend when you hammer it into timber or masonry

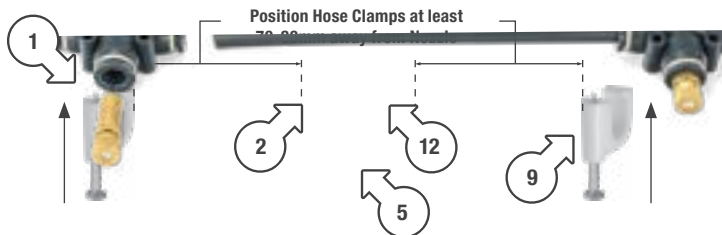

- HINT 1:** for a discrete *misting system*, discard **HOSE CLAMPS** and install  $\varnothing 3.2 \times 30$ mm masonry nails into holes directly on **MISTING FITTINGS** [12]
- HINT 2:** run **PIPEWORK** along mortar joints in brickwork. Hammer the **HOSE CLAMPS** into the brickwork for a reliable result
- HINT 3:** use a **HOSE CLAMP** on each side of a **MISTING TEE** to ensure the **TEE** is firmly positioned and misting in the correct direction
- HINT 4:** if hammering into metal, the correct nails will need to be purchased
- HINT 5:** avoid installing the **MISTING TUBE** in direct sunlight as this may cause the **TUBE** to go brittle over time

# Installation (continued)

## Flushing the System

---

- i** Perhaps the most important part of the installation process is to properly flush the system
1. Remove ALL **MISTING JETS** and connect the water and run for 4 or 5 min.
    - i** This will ensure all dirt and pipe swarf is flushed from the system. If this is not done, **MISTING JETS** will clog and not work correctly
    - i** The hole size in the **MISTING JETS** is extremely small. It is like this to ensure that the water particle is very small—like a mist
  2. After misting system has been flushed, attach **MISTING JETS** to **FITTINGS**

## Water Filter

---

- ⚠** **It is highly recommended that the filter be installed immediately after the connection to the water source**
- i** The principle of evaporative cooling relies on very small volumes of water evaporating and absorbing the ambient heat, it is critical the water entering your **7m Misting System** is clean and free of all particles that will not pass through the very small hole in the misting jet
- i** From time to time it may be necessary to clean the filter. This is best done by using cleaning solution like vinegar, available at your hardware store
- i** This will not only assist cleaning solid particles away, but it will dissolve calcium and iron deposits that build up as water evaporates in the filter and **MISTING JETS**

# Installation (continued)

## Auto Drain Valve

---

- ⚠ Do not remove the end of AUTO DRAIN VALVE unless blocked. There is a very small ball inside and if opened the ball will fall out**
- i** The **AUTO DRAIN VALVE** is an important component in your *7m misting system*
- i** It stops **MISTING JETS** from “dripping” and “dribbling”
- i** The **VALVE** also stops the build up of precipitated salts (like calcium and iron) in the **MISTING PIPEWORK**
- i** Install your **AUTO DRAIN VALVE** at a low point in the system
- i** The **AUTO DRAIN VALVE** will automatically release the pressure in the line and then “dump” water in the **MISTING TUBE** “above” the level of the **AUTO DRAIN VALVE** when water is turned off
- i** Position **AUTO DRAIN VALVE** where water can run freely—for example, let it “dump” water into a drain or garden area

# Maintenance

## Drain Water from your System

---

- i** When your **7m Misting system** is not in use, drain all water from it
- i** If using an **AUTOMATIC DRAINING VALVE**, this job will happen automatically

## Clean Nozzles

---

- i** Periodically clean all **NOZZLES** by soaking them in a solution of vinegar, or similar calcium and iron remover

## Flush System

---

- i** Periodically remove all **NOZZLES** and flush your **misting system** by running water through it for 4 or 5 min.

## Clean Filter

---

- i** Periodically clean the **MISTING FILTER** by soaking in a solution of vinegar to remove calcium and iron build up

## Clean Nozzles

---

- i** If **NOZZLES** are “dripping” or not misting properly, remove them and soak in cleaning solution like vinegar or similar calcium and iron remover
- i** If this fails to clean the **MISTING JET**, it is highly recommended to purchase the Holman Misting Expansion Kit and replace jets as required

## Need help? Just ask!

The Holman website has a host of additional information on features. Head to [support.holmanindustries.com.au](https://support.holmanindustries.com.au) for more tips, tricks and support content.

If you still need help, feel free to email our friendly Customer Service team at [support@holmanindustries.com.au](mailto:support@holmanindustries.com.au) or call at **08 9416 9999**.



SCAN FOR MORE INFO



**Thanks for being a  
#SMARTGARDENER**



**We really appreciate having you as a customer,  
and would like to say thank you for choosing us.**

We recommend registering your new product on our website. This will ensure we have a copy of your purchase and activate an extended warranty. Keep up to date with relevant product information and special offers available through our newsletter.



[www.holmanindustries.com.au/product-registration/](http://www.holmanindustries.com.au/product-registration/)

**HOLMAN**

For the #SMARTGARDENER   